

RENUMBERING	
YEAR	No.
1895	C.No. 19
-	C.NAT. 81
1922	C.NAT. 41

FLOOR PLAN DWG. 3W-3363-B

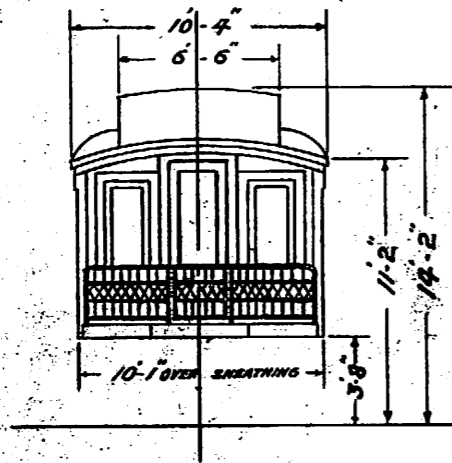

**CANADIAN NATIONAL RAILWAYS**  
MECHANICAL DEPARTMENT  
WINNIPEG.

50'-0" BUSINESS CAR

CLASS PV-50-U

NO OF CARS

CAR No.

1

41

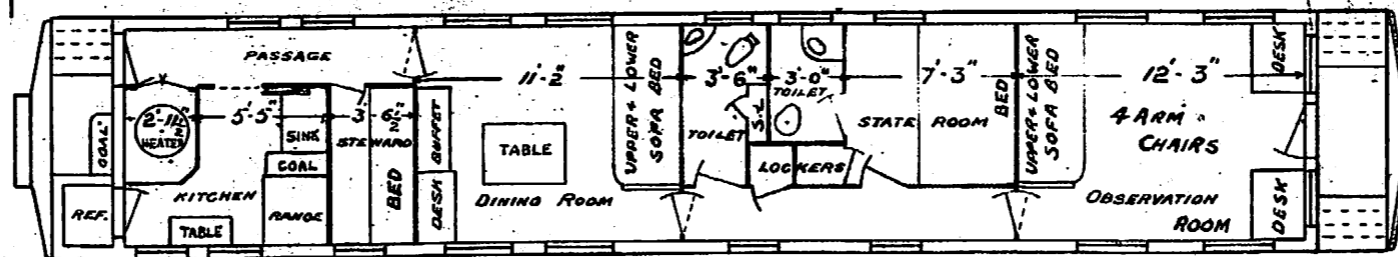
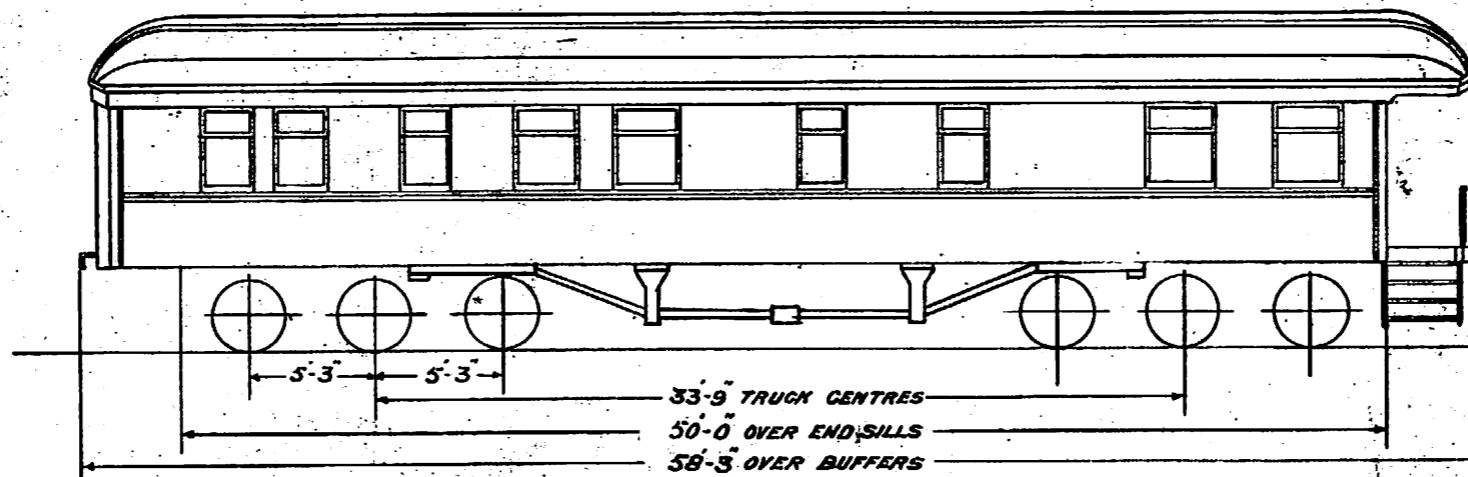

ISSUE: - A.B.C.

NOV. 24/25. T.W.

*Handwritten signature/initials*